

Angular Contact Ball Bearings

Brass cage angular contact ball bearing-7306 BECBY

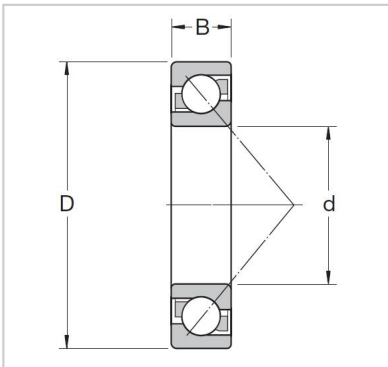

Abutment and fillet dimensions

Db max.	7306 BECBY
Da max.	-
da min.	30
rb max.	72
ra max.	19

Dimensions

a	34.5
r3,4 min.	21.2
r1,2 min	0.9
D1	12 000
d2	12 000
d1	0.34

Mass

KG	46.6
----	------

Speed ratings r/min

Limiting speed	37.9
Reference speed	56.5

Fatigue load limit

Pu kN	1.1
-------	-----

Basic load ratings KN

dynamic C kN	0.6
static Co kN	31

Basic design bearing

B mm	37
D mm	65
d mm	67.8

Basic design bearing

1	
---	--

Designations

Universally matchable bearing	0.6
-------------------------------	-----